



Technical data sheet for Dewar carrying flasks type 26-29 B or B-E

Area of application

- laboratory technique
- medicinal technique
- Biotechnology
- storing and company internal short-distance transport
- for liquid or solid medias and solid matters
- pressure-less space for coolants



Dewar flask 26 B

Features of performance

- reliably and economically
- Dewar flasks according to DIN 12492
- glass material according to ISO 3585
- nominal capacity from 1 to 4 litres
- protective casing out of blue-coated metal or stainless steel



Dewar flask 26 B-E

Description of complete flasks

Types and accessories

- B = blue-coated protective casing out of metal
- B-E = protective casing out of stainless steel
- carrying handle = pure aluminium
- lid = polyethylene, white
- clamps = stainless steel, electrolytic polished

Temperature ranges

- glass refill from - 200°C to + 150°C, for a short time +200°C
- lid to + 80°C
- casing with mounting rubber and Latizell buffer to + 60°C

Pressure range

- pressure - less

Description of glass Dewar flask

Material

- borosilicate glass 3.3 ISO 3585

Chemical characteristics

- hydrolytic resistance: according to ISO 719 (98°C)
- hydrolytic resistance: according to ISO 720 (121°C)
- acid resistance: according to ISO 1776
- alkaline resistance: according to ISO 695-A2

Physical characteristics

- linear expansion coefficient: $3,3 \times 10^{-6} 1/K$ (in between 20-300°C)
- density: $2,23 \text{ g/cm}^3$
- specific thermal capacity: 910 J/kg K
- transformation temperature: 525°C

Vacuum

- $> 5 \times 10^{-6} \text{ mbar}$

Silvering

- fully silvered

KGW - ISOTHERM

Karlsruher Glastechnisches Werk
76185 Karlsruhe Gablonzerstraße 6
Tel: 0721 95897-0 Fax: 0721 95897-77
E-Mail: info@KGW-ISOTHERM.COM
Internet: www.KGW-ISOTHERM.COM

KGW-ISOTHERM Datenblatt E 26-29 / 04-2011
Seite 1 von 2



Technical data sheet for Dewar carrying flasks type 26-29 B or B-E

Special types

- small insulation flasks with bore hole in the lid for gaseous medias
- small insulation flasks with PTFE lid
- small insulation flasks with silicone sealed lid

Safety advises and regulations

- always wear protective glasses and protective gloves
- national regulations for laboratories
- company- internal regulations
- safety regulations for handling with liquid gases
- ADR regulations

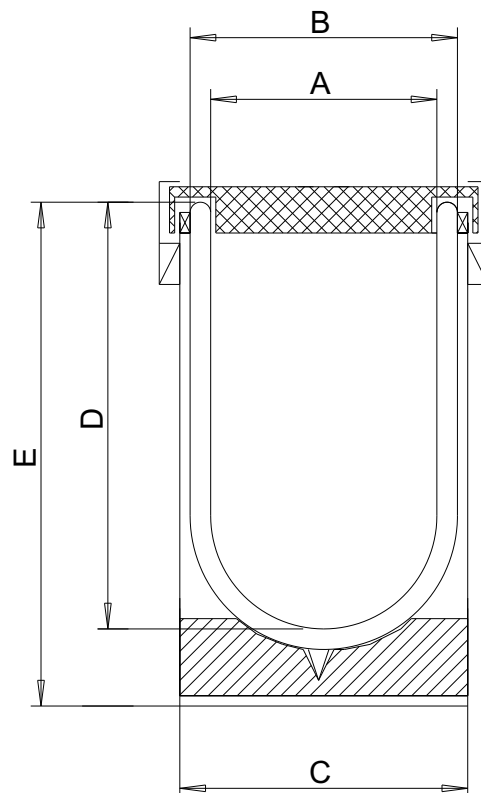

Measurements and order data

Technische Angaben / Technical Specifications / Caractéristiques techniques									
Typ	max. Inhalt	A	B	C	D	E	Gewicht	Standzeit LN2	Verdampfungsrate LN2
Type	max. Content						Weight	Holding time LN2	Evaporation rate LN2
Types	Capacité max.						poids	Durabilité LN2	Taux d'évaporation LN2
	ca. [L]	mm	mm	mm	mm	mm	ca. [kg]	ca. [h]	ca. [L / d]
26 B (26BE)	1	100	120	130	150	215	1,2	18	1,1
27 B (27BE)	2	138	160	165	170	245	2,0	26	1,7
28 B (28BE)	3	138	160	165	230	305	2,5	44	1,5
29 B (28BE)	4	138	160	165	310	385	3,0	75	1,3
Artikel-Nummern / Article numbers / Référence									
Typ	Artikel Nr.				Typ	Artikel Nr.		Ersatzglas	Artikel Nr.
Type	Article No.				Type	Article No.		Glass Refill	Article No.
Types	Référence				Types	Référence		Récipient replacement	Référence
26 B	1211				26 BE	1221		26 A	1201
27 B	1212				27 BE	1222		27 A	1202
28 B	1213				28 BE	1223		28 A	1203
29 B	1214				29 BE	1224		29 A	1204

1 l, sklo/plech, vč. víka, cena: ...3.458,- bez DPH

1 l, sklo/nerez. vč. víka, cena ... 3.510,- Kč bez DPH

KGW - ISOTHERM

Karlsruher Glastechnisches Werk
76185 Karlsruhe Gablonzerstraße 6
Tel: 0721 95897-0 Fax: 0721 95897-77
E-Mail: info@KGW-ISOTHERM.COM
Internet: www.KGW-ISOTHERM.COM

KGW-ISOTHERM Datenblatt E 26-29 / 04-2011
Seite 2 von 2